



MID ATLANTIC SERIES CATALOG

WALL CABINET CONSTRUCTION



BASE CABINET CONSTRUCTION



CONSTRUCTION DETAILS

1 = Concealed 6 ways adjustable, 110 Degree opening angle (Soft close door system)

2 = Top, Bottom and Side Panels (Wall): 1/2" Plywood with wood veneer

3 = All metal brackets

4 = Undermount, Heavy-duty, Self-close Glide System, full extension and 1/2" Thick hardwood dovetail drawer box

5 = 3M soft door & drawer bumper

D-SERIES



D2 White Shaker



D3 Shallow Green



D6 Dove Grey

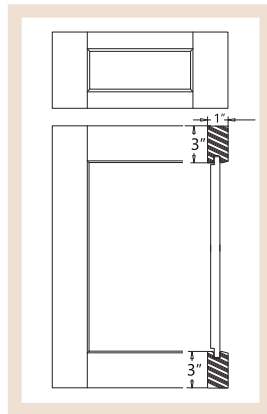
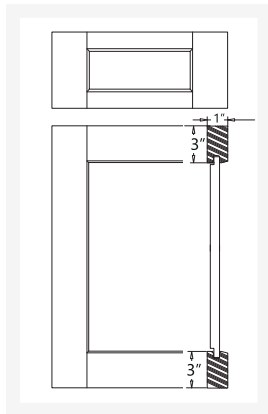
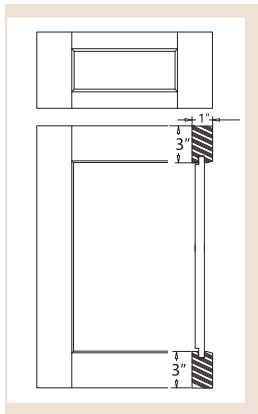

D-SERIES



D8 Black Swan



D9 Pearl White

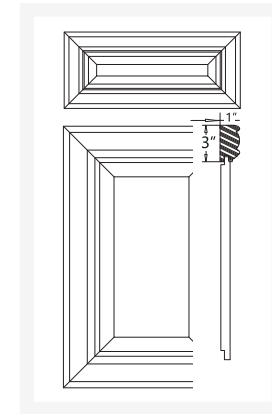
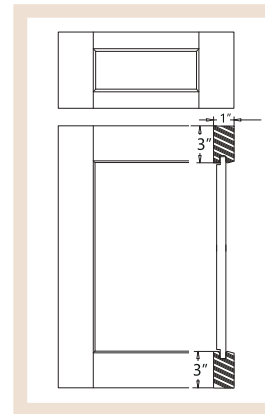

G SERIES



G1 Espresso Shake

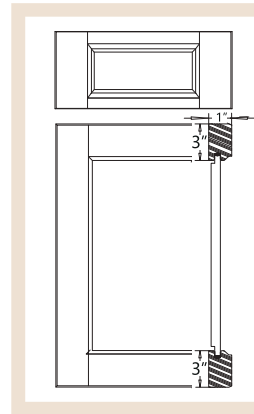

All Series Are Made From Maple Doors

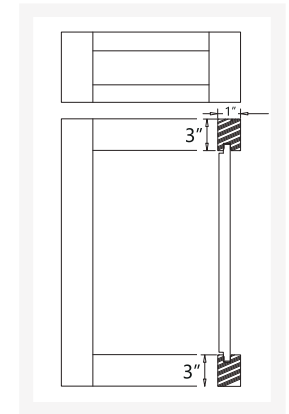
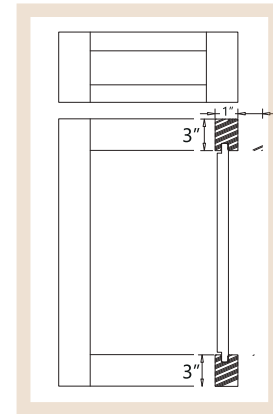
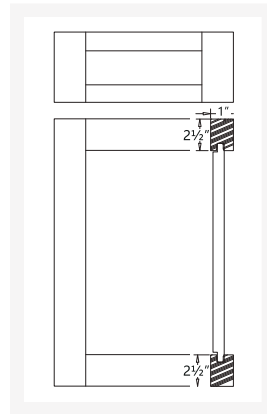
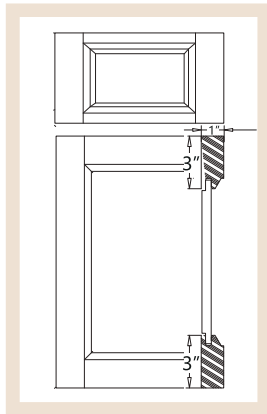
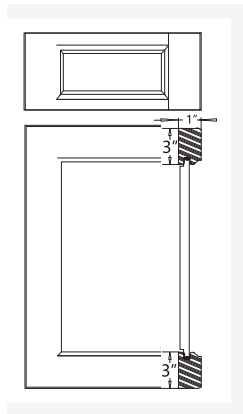
G SERIES**G4 Grey Shaker****G8 Royal Blue****L-SERIES
-ECONOMIC-****L2 Aveley****S SERIES****S1 Ash Gaey****S2 Honey Shaker**

All Series Are Made From Maple Doors

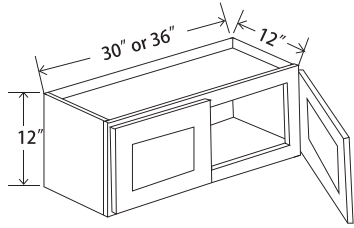

Wall Cabinet Double Doors, 12"H

- W3012 / W3612
- No shelf

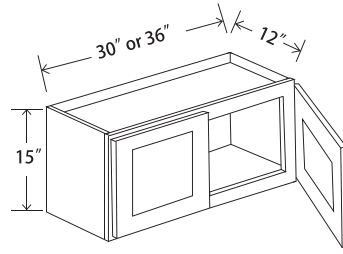

Wall Cabinet Double Doors, 15"H

- W3015 / W3615
- 15" W or 18" W custom available
- No shelf

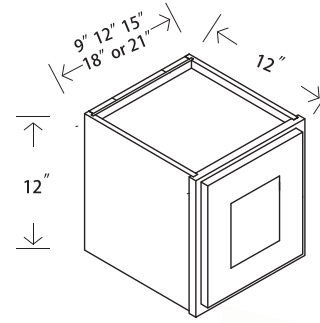

Wall Cabinet Single Doors

- W0912 / W1212 / W1512 / W1812 / W2112
- No shelf

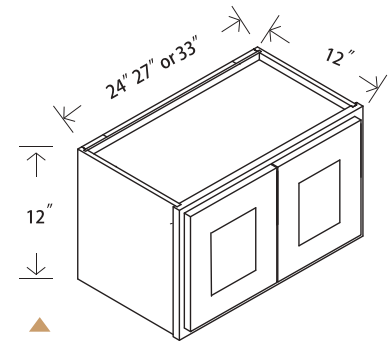

Wall Cabinet Double Doors

- W2412 / W2712 / W3312
- No shelf

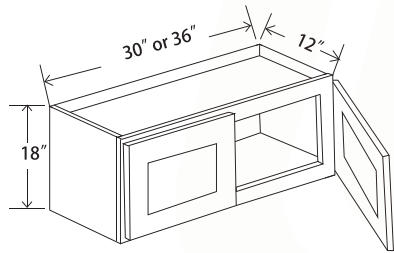

Wall Cabinet Double Doors, 18"H

- W3018 / W3618
- 15" W or 18" W custom available
- No shelf

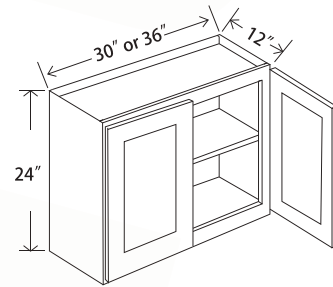

Wall Cabinet Double Doors, 24"H

- W3024 / W3624
- 15" W or 18" W custom available
- One adjustable shelf

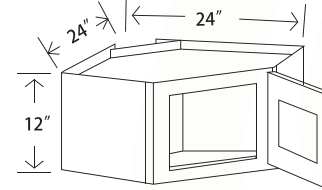

Diagonal Corner Wall Single Door

- WDC241212
- 12" H custom available
- No shelf

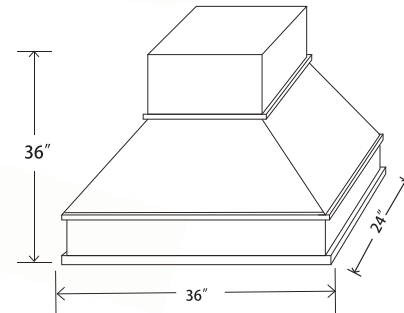

Range Hood Cover

- RH36
- Insert opening 33" W x 22" D

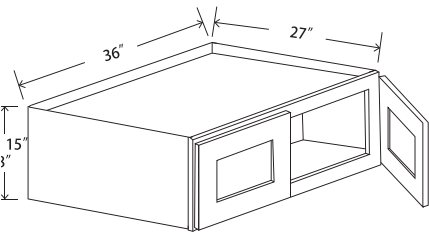

Refrigerator Wall Cabinet Double Doors

- W361227 / W361527 / W361827
- No shelf

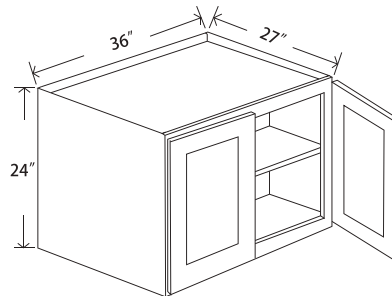

Refrigerator Wall Cabinet Double Doors, 24"H

- W362427
- One adjustable shelf

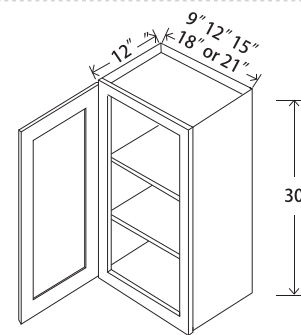

Wall Cabinet Single Door, 30"H

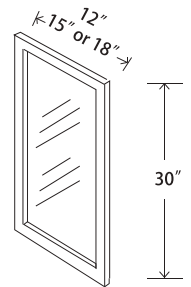

Wall Cabinet Single Glass Door, 30"H

- WG1230 / WG1530 / WG1830

All Size Glass Doors Custom Available

All Size Glass Doors Custom Available

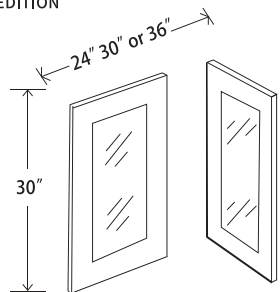

Wall Cabinet Double Glass Doors, 30"H

- WG2430 / WG3030 / WG3630

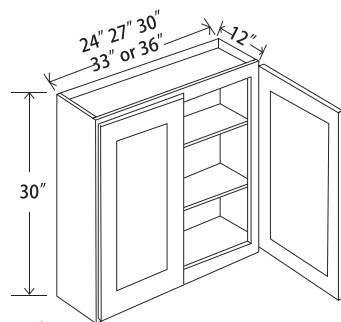

Wall Cabinet Double Doors, 30"H

- W2430 / W2730 / W3030 / W3330 / W3630
- Two adjustable shelves

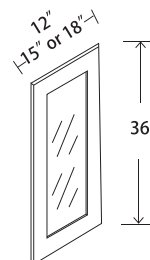

Wall Cabinet Single Glass Door, 36"H

- WG1236 / WG1536 / WG1836

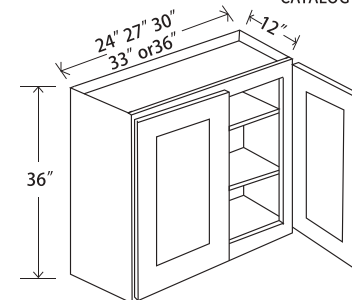

Wall Cabinet Double Doors, 36"H

- W2436 / W2736 / W3036
- W3336 / W3636
- Two adjustable shelves

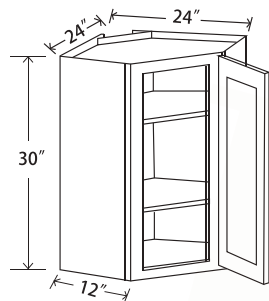

Diagonal Corner Wall Single Door 30"H

- WDC243012
- Two adjustable shelves

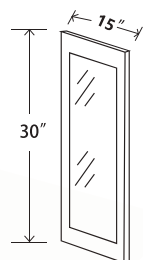

Diagonal Corner Wall Single Glass Door 30"H

- WDCG243012

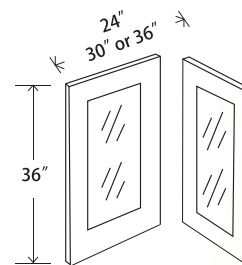

Wall Cabinet Double Glass Doors, 36"H

- WG2436 / WG3036 / WG3636

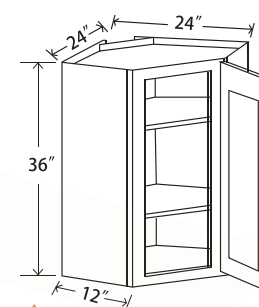

Diagonal Corner Wall Single Door 36"H

- WDC243612
- Two adjustable shelves

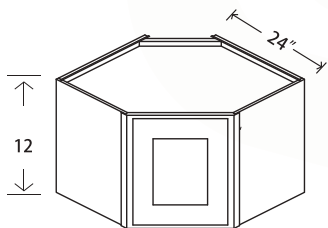

Diagonal Corner Wall Single Door 12"H

- WDC2412
- Two adjustable shelves

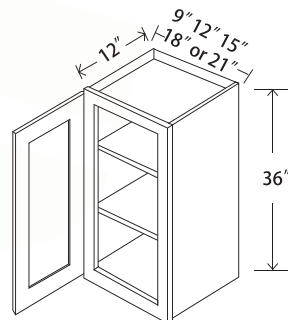

Wall Cabinet Single Door, 36"H

- W0936 / W1236 / W1536
- W1836 / W2136
- Two adjustable shelves

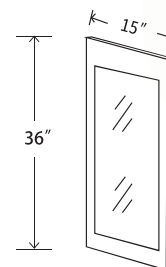

Diagonal Corner Wall Single Glass Door 36"H

- WDCG243612

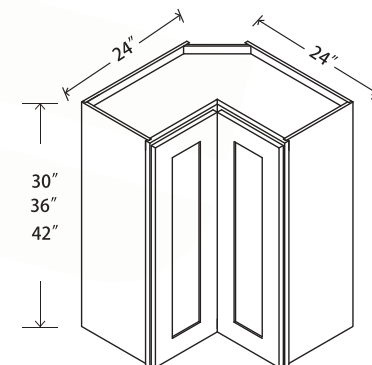

Diagonal Corner Wall Single Door

- WLC2412

All Size Glass Doors Custom Available

All Size Glass Doors Custom Available

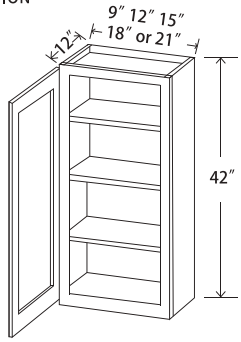
**Wall Cabinet Single Door, 42"H**

- W0942 / W1242 / W1542 / W1842 / W2142
- Three adjustable shelves

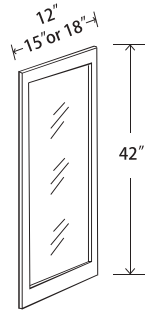
**Wall Cabinet Single Glass Door, 42"H**

- WG1242 / WG1542 / WG1842

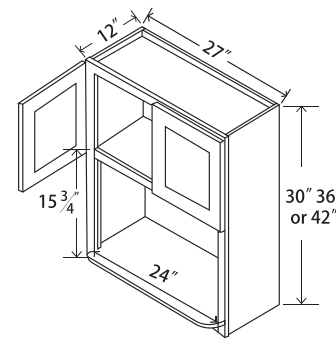
**Microwave Wall Cabinet**

- WMC2730 / WMC2736 / WMC2742

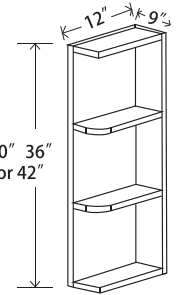
**Open End Shelf**

- WEOS0930 / WEOS0936 / WEOS0942
- Matching color interior

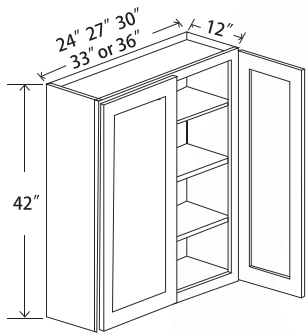
**Wall Cabinet Double Doors, 42"H**

- W2442 / W2742 / W3042 / W3342 / W3642
- Three adjustable shelves

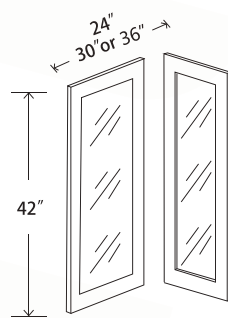
**Wall Cabinet Double Glass Doors, 42"H**

- WG2442 / WG3042 / WG3642

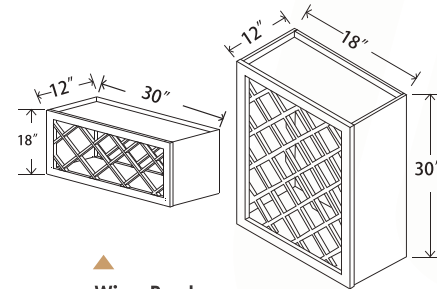
**Wine Rack**

- WRC3018

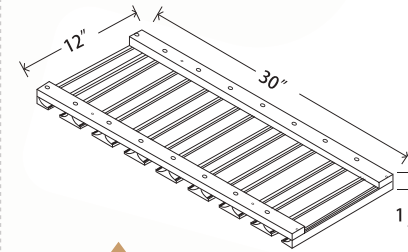
**Glass Holder**

- GH30

All Size Glass Doors Custom Available

All Size Glass Doors Custom Available

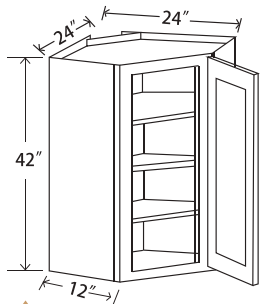
**Diagonal Corner Wall Single Door 42"H**

- WDC244212
- Three adjustable shelves

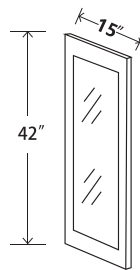
**Diagonal Corner Wall Glass Door 42"H**

- WDCG244212

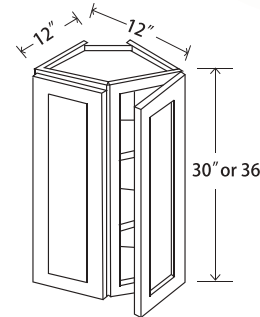
**Wall End Corner Cabinet 30" or 36"H
- 2 Doors, 2 shelves**

- WEC1230 / WEC1236
- Two adjustable shelves

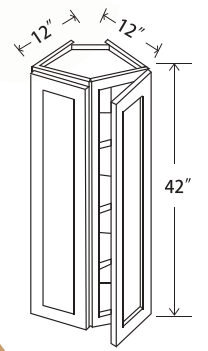
**Wall End Corner Cabinet 42"H
- 2 Doors, 3 shelves**

- WEC1242
- Three adjustable shelves

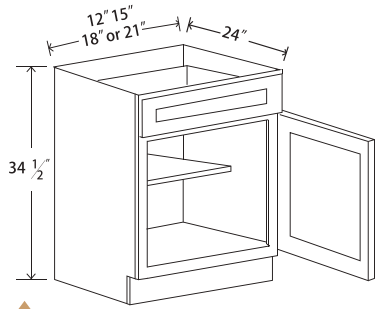

Base Cabinet Single Door, 34 1/2" H

- B09 / B12 / B15 / B18 / B21
- One drawer
- One adjustable shelf

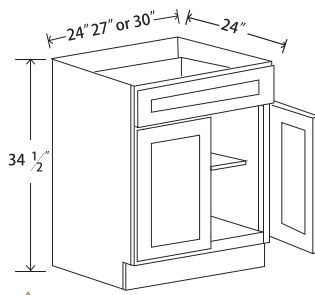

Base Cabinet Double Doors

- B24 / B27 / B30
- One drawer
- One adjustable shelf

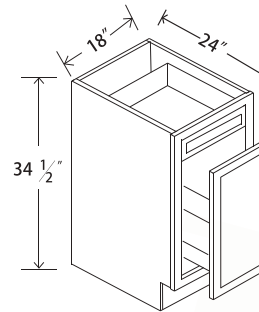

Wastebasket Cabinet-1 Drawer, 1 Tall Wastebasket Drawer

- BWBKT18
- Trash bins not included

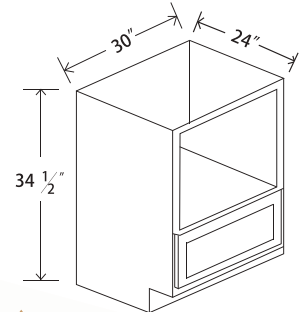

Base Microwave Cabinet - 1 Drawer

- BMC30
- Insert opening 27"W x 16 1/4" H

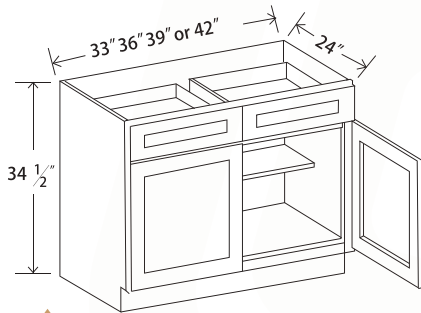

Base Cabinet Double Doors

- B33 / B36 / B39 / B42
- Two drawers
- One adjustable shelf

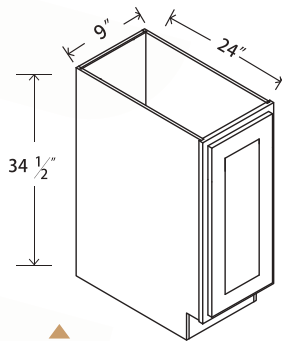

Base Cabinet Double Doors

- FHD09

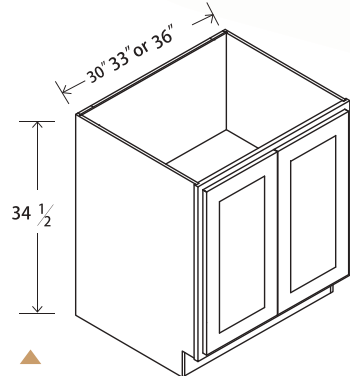

Base Cabinet Double Doors

- FHD30 / FHD33 / FHD36

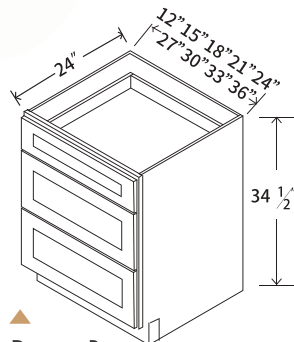

Drawer Base

- DB12 / DB15 / DB18 / DB21 / DB24
- DB27 / DB30 / DB33 / DB36

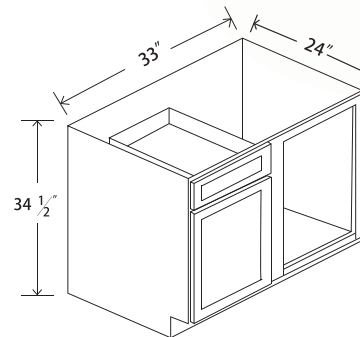

33" Blind Corner Cabinet-1 Door, 1 Drawer, 1 Shelf

- BBC33-9
 - Must have 42" of space to install
- LEFT OR RIGHT

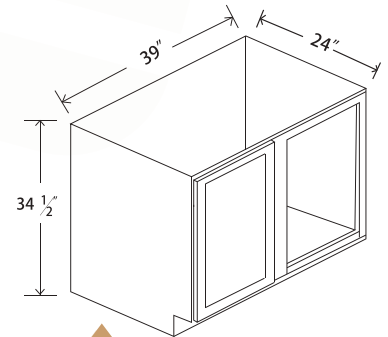

39" Blind Corner Cabinet (Door Left Or Right) - 1 Full Height Door

- BBC39FHD-9
 - Must have 48" of space to install
- LEFT OR RIGHT

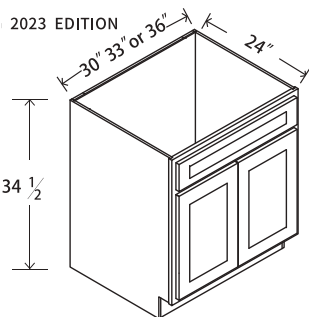

Sink Base

- SB30 / SB33 / SB36
- One dummy drawer

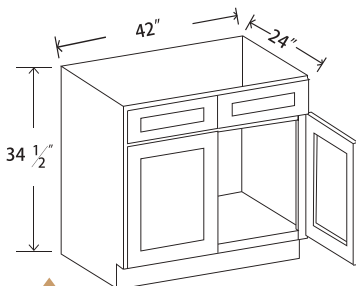

Sink Base

- SB42
- Size 39" custom available
- Two dummy drawer

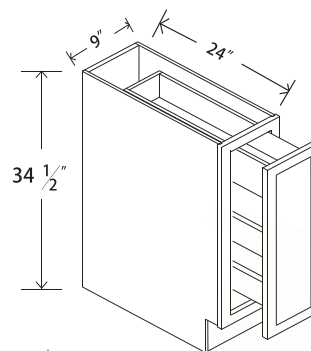

Spice Rack Cabinet -1 Full Height Door Pull-Out Spice Rack

- SP09

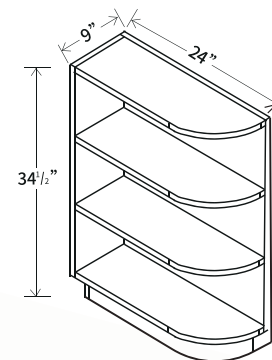

Base End Shelf

- BES09
- LEFT OR RIGHT

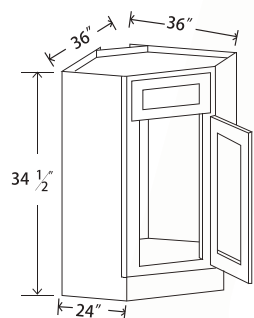

Corner Sink Base Cabinet

- SBA36
- One dummy drawer

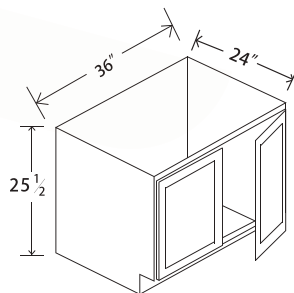

Farmhouse Sink Base Cabinet - 2 Doors

- FSB36

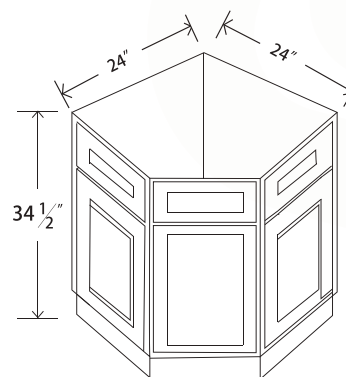

Base End Cabinet - 2 Doors,1 False Door, 3 Fales Drawers,1 Shelf

- BEC24

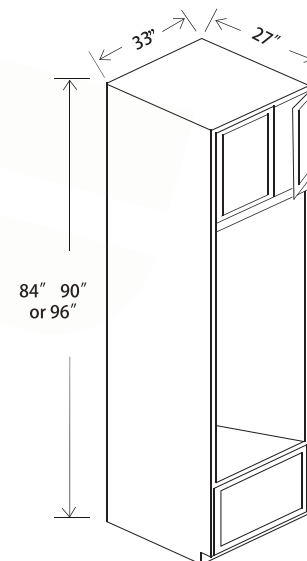

Double Oven Cabinet - 2 Doors, 1 Drawer

- OVD338427 / OVD339027 / OVD339627
- Insert opening 48 1/2" H x 30" W

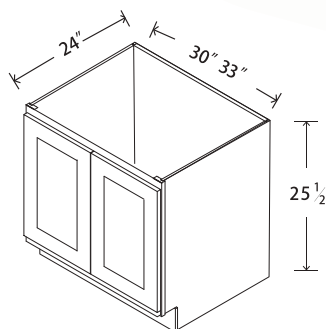

Farmhouse Sink Base Cabinet - 2 Doors

- FSB30 / FSB33

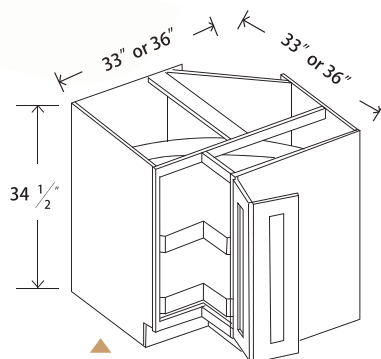

Lazy Susan Cabinet

- LZS33 / LZS36
- Two wooden trays

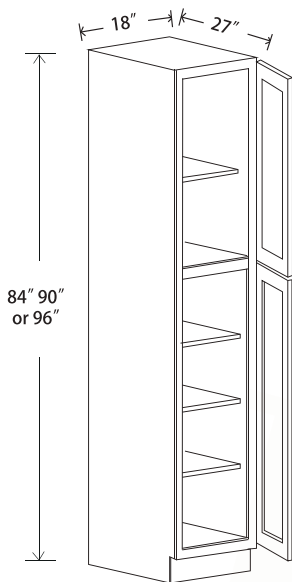

Utility Pantry

- WP188427 / WP189027 / WP189627
- One adjustable top shelves
- Note: 84"H Two bottom shelves
90" H or 96" H Three bottom shelves
- Note:
Roll Out Tray
kits available for utility cabinets'
See page 41"

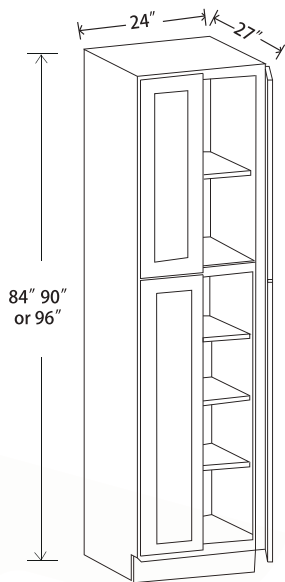

Utility Pantry

- WP248427 / WP249027 / WP249627
- One adjustable top shelves
- Note: 84"H Two bottom shelves
90" H or 96" H Three bottom shelves
- Note:
Roll Out Tray
kits available for utility cabinets'
See page 41"

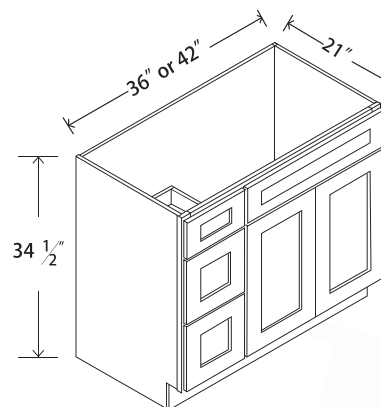

Vanity Combo

- VAN36DL / VAN42DL

VAN36DL or 42" combo with 2 DRAWERS on LEFT OR RIGHT
VAN36DR or 42" combo with 2 DRAWERS on LEFT OR RIGHT

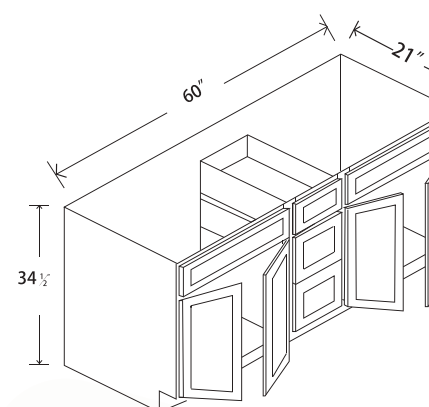

Vanity Sink Base Cabinet- 4 Doors, 1 Drawer, 2 Deep Drawers

- VAN60DD-3

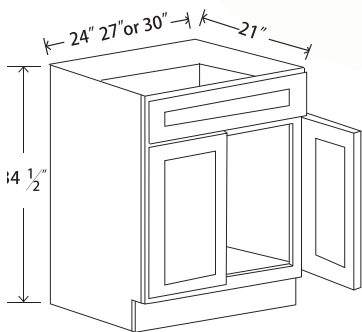

Vanity Sink Base

- VAN24 / VAN27 / VAN30

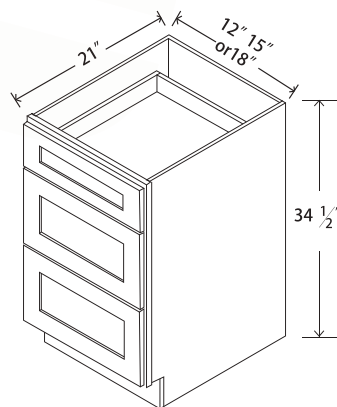

Vanity Drawer Base Cabinet

- VDB12 / VDB15 / VDB18

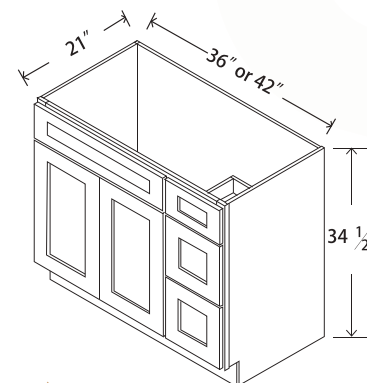

Vanity Combo

- VAN36DR / VAN42DR

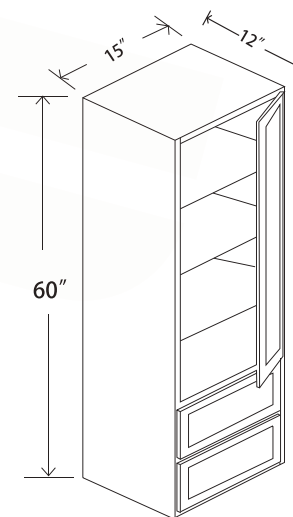

Tall Counter Linen Cabinet - 1 Door 2 Drawers, 3 Shelves

- CL156012

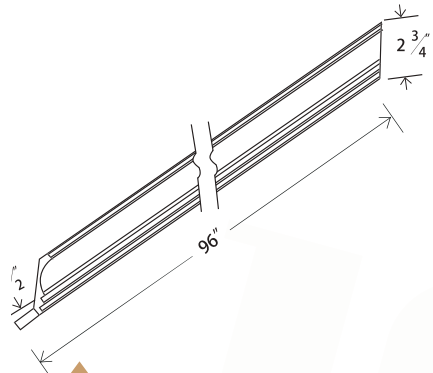
**Crown Molding**

• ACM 2.5

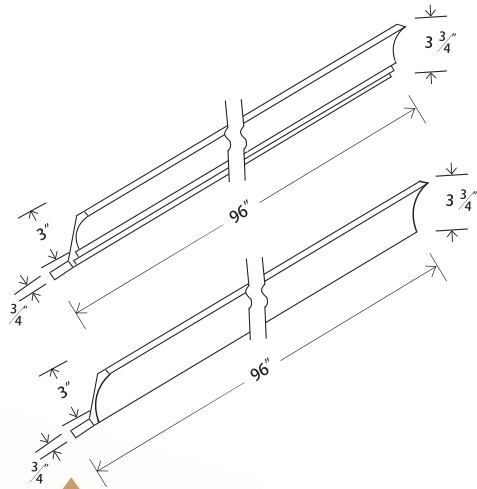
**Crown Molding**

• CCM8 / COVE MOLDING

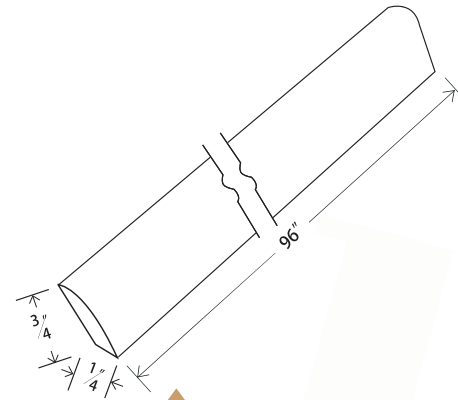
**Scribe Molding**

• SCRIBE MOLDING

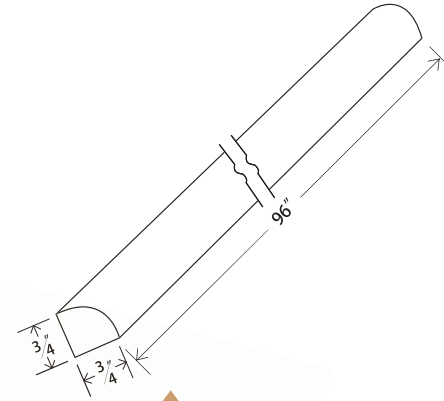
**Shoe Molding**

• SHOE MOLDING

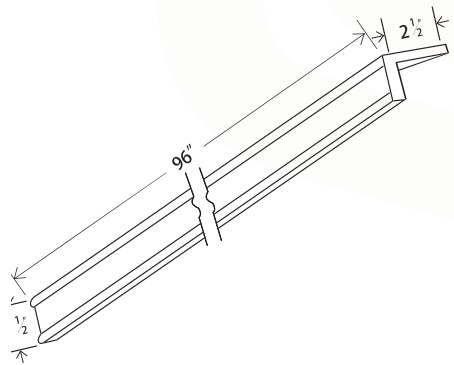
**Light Rail Molding**

• TLR8

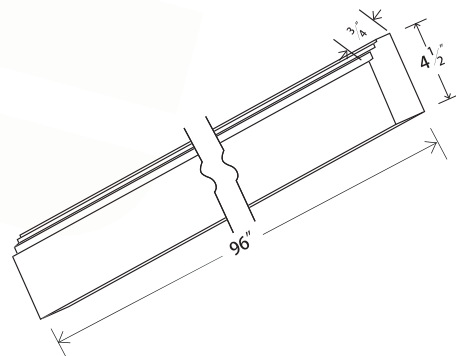
**Base Molding**

• BASE MOLDING

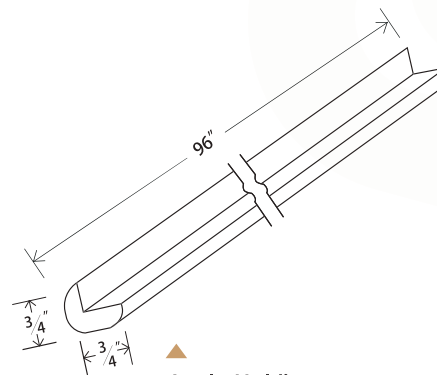
**Angle Molding**

• ANGLE MOLDING

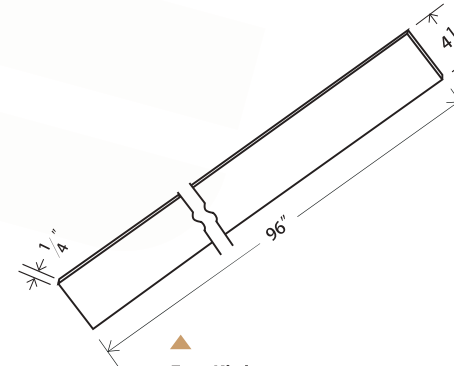
**Toe Kick**

• TK8

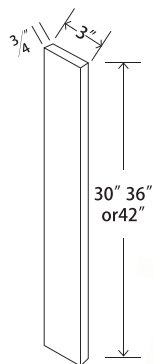

▲
Wall Filler

- WF3*30 / WF3*36 / WF3*42

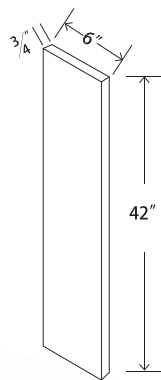

▲
Wall Filler

- WF6*42

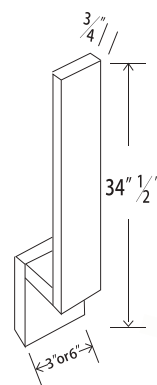

▲
Base Filler

- BF3 / BF6

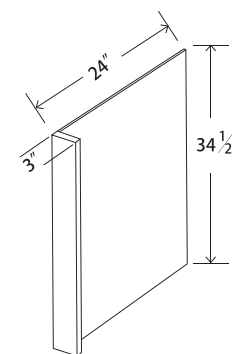

▲
Dishwasher Panel

- DWP3

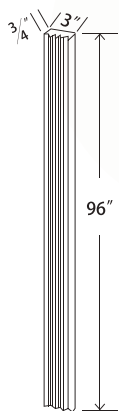

▲
Tall Fluted Filler

- FFWF3*96

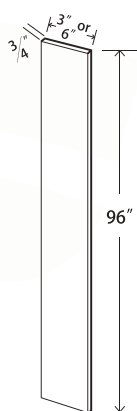

▲
Tall Filler

- F3*96 / F6*96

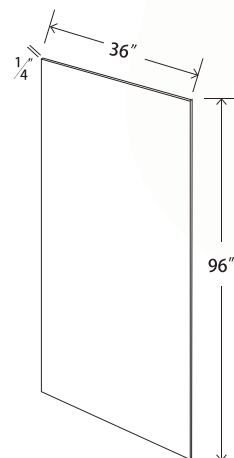

▲
Skin Panel

- PANEL 36" *96"

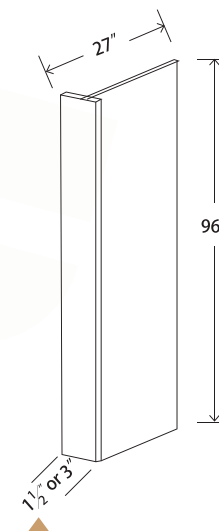

▲
Refrigerator Panel

- RRP27(1.5") / RRP27 (3")
- 1 1/2" OR 3"

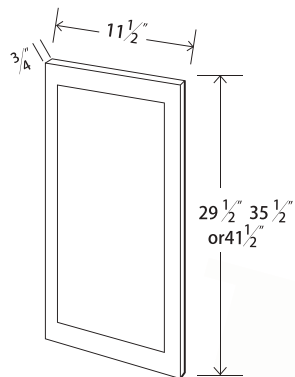

Wall Decorative Door Panel

- WDD30 / WDD36 / WDD42

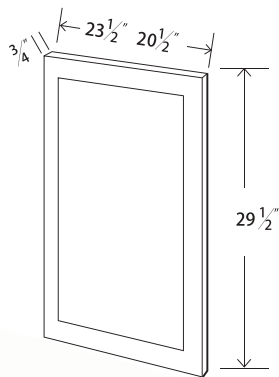

Base Decorative Door Panel

- BDD24 / BDD21

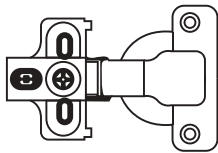

Hinge

- SOFT-CLOSE
- Adjustable

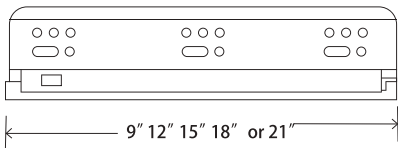

Drawer Slides

- SOFT-CLOSE
- Heavy Duty • Adjustable

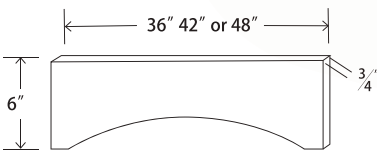

Valance

- VAL36 / VAL42 / VAL48

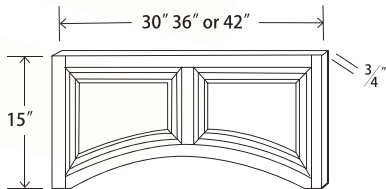

Decorative Valance

- RPV30 / RPV36 / RPV42

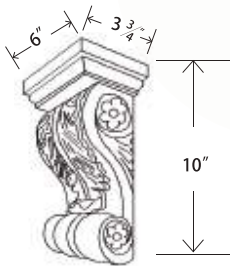

Decorative Corbel

- CORBEL6"

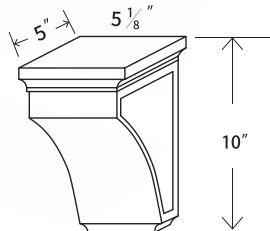

Corbel

- CORBEL5 1/8"

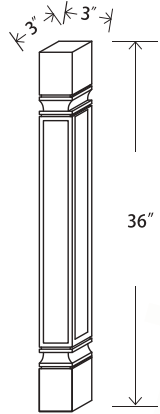

▲
Decorative Corbel
—
• DLS3*3*36"

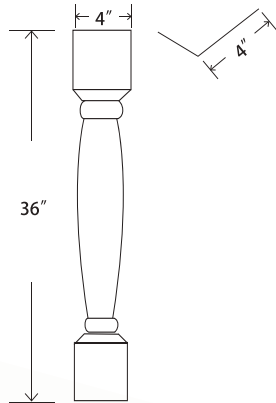

▲
Decorative Corbel
—
• DLS4*4*36"

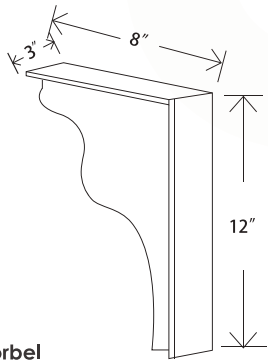

▲
Corbel
—
• CORBEL 8x12"

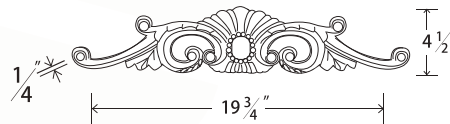

▲
Onlay Applique
—
• ONLAY APPLIQUE

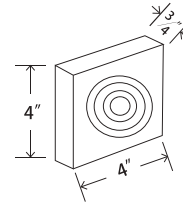

▲
Rosette Block
—
• ROSETTE 3*3

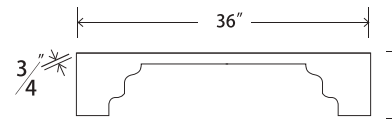

▲
Furniture Base
—
• FURNITURE BASE

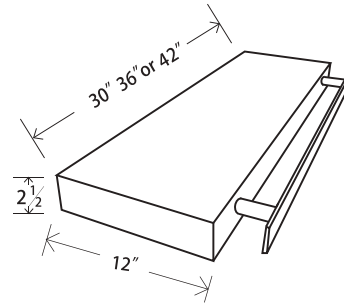

▲
Floating shelves
—
• Floating shelves 30
Floating shelves 36
Floating shelves 42

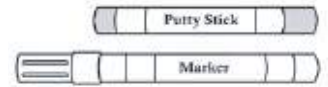

▲
Touch Up Kit
—
• 1-Putty stick / 1-Marker /
1-Plastic Razor Blade

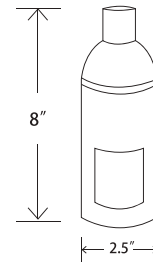

▲
Spray Paint
—